

# **Attachment A**

**Project Scope and Additional Scope items**

## **Attachment A – Project Scope and Additional Scope items**

### **Loftus Street Upgrade**

#### **Summary of Changes and Additions to Initial Project Scope**

The project scope has changed from the City's initial proposal developed in 2021 to incorporate Transport for NSW(TfNSW) and stakeholder requirements.

Upon commencing work on the project, the City started discussion with Transport for NSW about the proposed works. Transport for NSW raised concern about the impact that the proposed footpath extension on the northern side of Reiby Place would have on the re-developments that are currently taking place on Pitt Street:

- 1 Alfred Street
- 55-57 Pitt Street

For this reason, Transport for NSW granted approval to undertake Stage 1 of the works and restricted the start of Stage 2 until those construction projects are complete. Stage 2 has been removed from the scope of this project and may be incorporated into a future project, subject to the granting of relevant approvals.

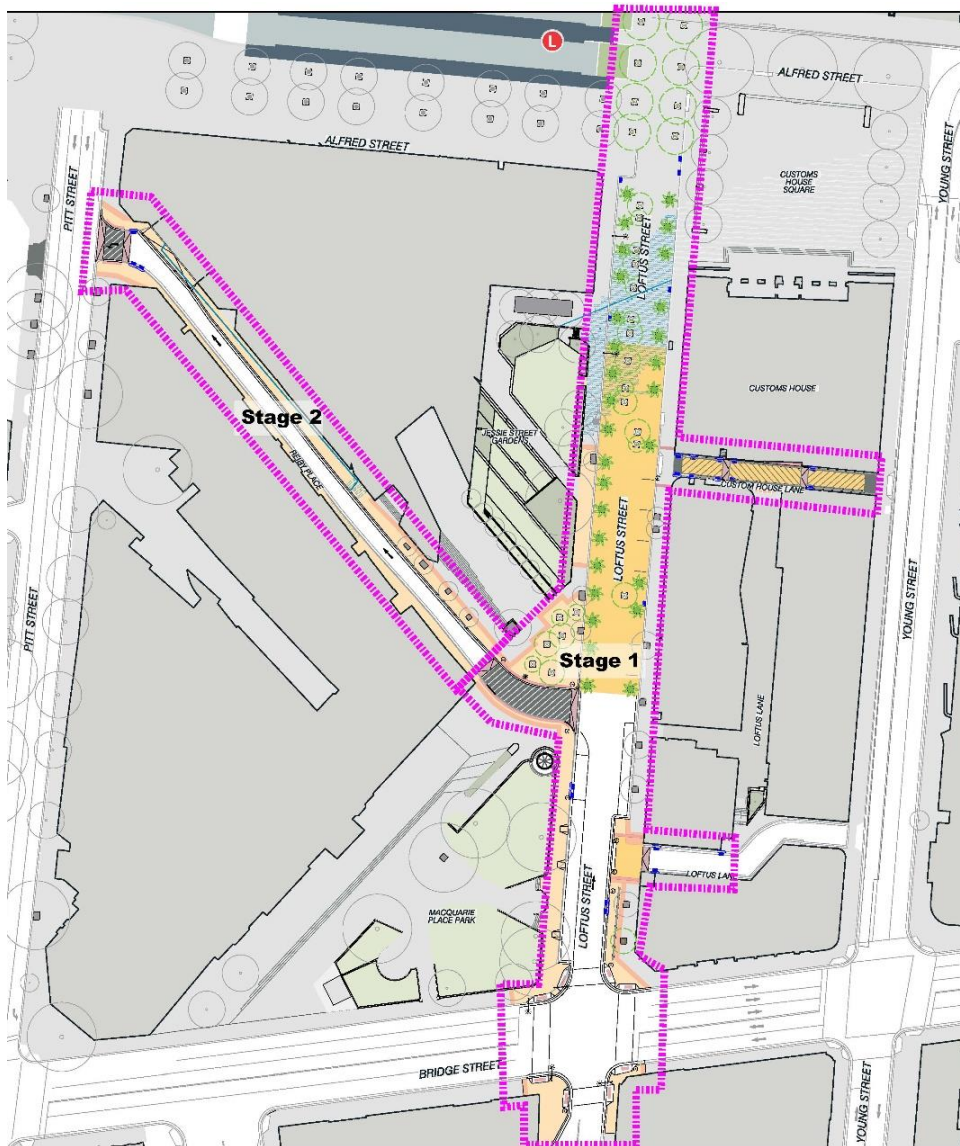

### Additional Project Scope

The following table summarises the changes in project scope associated with authority and stakeholder engagement. Refer to the Reference Designs below for additional details.

Change Item No.	Location	Change Summary	Additional Scope Required
1	Loftus Street and Alfred Street	Add to the existing avenue of street trees on Alfred Street and an additional row of shade/ canopy trees along Loftus Street.	Excavation for tree pits, including structural soil areas, utility service protection and tree planting.

<b>Change Item No.</b>	<b>Location</b>	<b>Change Summary</b>	<b>Additional Scope Required</b>
<b>2</b>	Customs House Lane	Introduction of a raised threshold in front of the entry to Customs House in line with Loftus Lane	Introduce a raised threshold on the road, footpath tie-in grading from Loftus Lane footpath to Custom House doorway, tactile ground surface indicators, utility service lid adjustments, and stormwater drainage infrastructure.
<b>3</b>	Customs House Lane	New inground lights	Additional pits, conduits and in-ground lights to enable feature lighting of the surface of Customs House Lane.
<b>4</b>	Loftus Street, north of Bridge Street	Existing footpath infrastructure at taxi ranks within the project site was identified as requiring upgrades to meet pending revisions to the Disability Standards for Accessible Public Transport.	Additional kerb ramps are to be constructed at the taxi rank.
<b>5</b>	Loftus Street and Loftus Lane	Construct continuous footpath treatment (CFT) to improve accessibility and pedestrian safety.	Amend road geometry, kerb and gutter, footpath pavement and grading, stormwater drainage infrastructure, bollards and tactile ground surface indicators.
<b>6</b>	Footpaths of Loftus St, north of Bridge St	In response to change item 6, the footpath gets extended, taking the opportunity of an existing no-stopping area in the road.	Four traffic lanes will be reduced to one lane in each direction at the signalised pedestrian crossing area. Footpath widening and street lighting will be amended to suit the new road geometry. Tree planting to fit the new footpath environment.

Change Item No.	Location	Change Summary	Additional Scope Required
7	South of the intersection of Loftus Street and Bridge St	The existing footpath does not adhere to equitable access requirements.	Reconstruct kerb ramps, amend traffic signal poles, lanterns and electrical assets; amend road geometry, signage and line marking, kerb and gutter alignment, footpath pavement and grading, street lighting and electrical infrastructure, and stormwater drainage infrastructure.

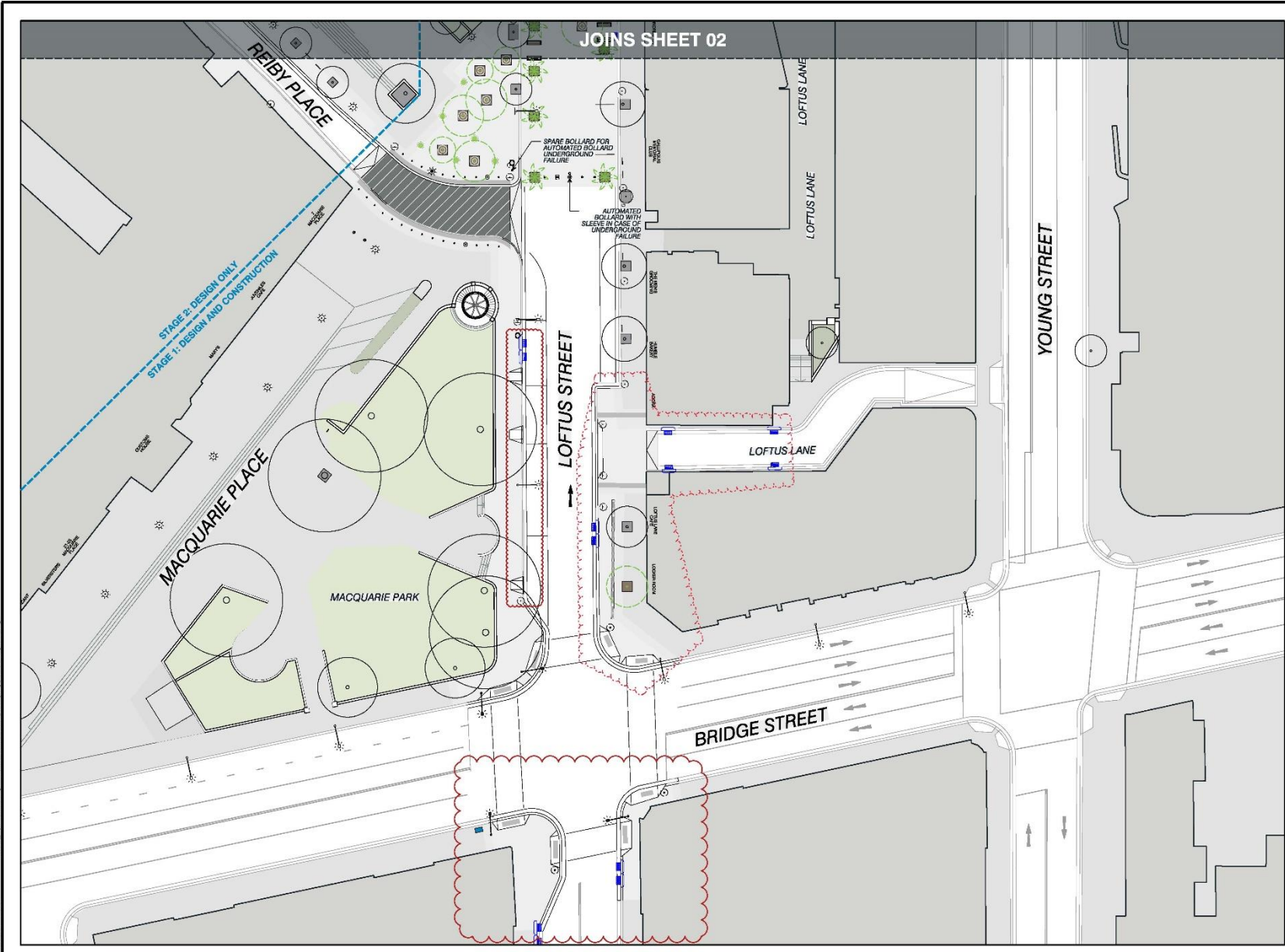

JOINS SHEET 02

**LEGEND**

**PROPOSED**

- BENCH PROPOSED
- PLANTER PROPOSED BY OTHERS
- KIOSK EXISTING
- BIN (120L) PROPOSED
- BIKE RACK PROPOSED
- BOLLARDS TZANNES - FIXED
- BOLLARDS TZANNES - REMOVABLE
- BOLLARDS LEDA - FIXED
- BOLLARDS LEDA - REMOVABLE
- BOLLARDS LEDA - AUTOMATED RETRACTABLE
- LIVISTONA AUSTRALIS PALM TREE
- FLINDERSIA AUSTRALIS TREE
- TRISTANIOPSIS LAURINA TREE
- TREE PIT POROUS
- TREE PIT GRATE
- TRENCH DRAIN
- KERB INLET PIT
- STREETLIGHT POLE
- FLOOR LIGHT FITTING
- GALVANISED POST
- TCS CABINET

**EXISTING**

- TREE
- TREE PIT - POROUS
- TREE PIT - GRATE
- MAIN SWITCH BOARD
- GALVANISED POST
- STREETLIGHT POLE

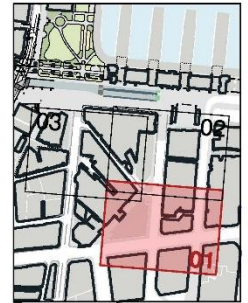

Revisions	No.	Date	Description
	A.	20.06.23	FOR REVIEW
	B.	21.07.23	ISSUE TO QUANTITY SURVEYOR
	C.	02.08.23	ISSUE TO QUANTITY SURVEYOR
	D.	22.08.23	ISSUE FOR TENDER
	E.	11.10.23	DESIGN UPDATE: BRIDGE/LOFTUS INTERSECTION ADDED LOFTUS ACCESSIBLE TAXI RAMP

Drawings that do not show status have not been verified by City Design and are not to be used for any purposes other than for preliminary reference. All dimensions on site plans are approximate. Use figures for reference only. Verify all dimensions on site before commencing works and refer any discrepancies to City Design.  
© City Design  
The information contained in this drawing remains the property of City Design and is not to be reused or copied without permission.

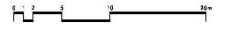

Designer  
**City of Sydney**  
City Design Unit

Town Hall House  
GPS Box 109  
Sydney NSW 2000  
Telephone: 02 9556 9922  
www.cityofsydney.nsw.gov.au



Project  
**Loftus Street**  
Pedestrianisation

Project No.  
**C33035**



Drawing  
Loftus Street  
Preliminary Design - General Arrangements Plans

Drawing Status  
**PRELIMINARY**

Scale	Sheet Size	Sheet	Issue
1:250	A1	01 of 03	E

Drawing Number  
DRG-101



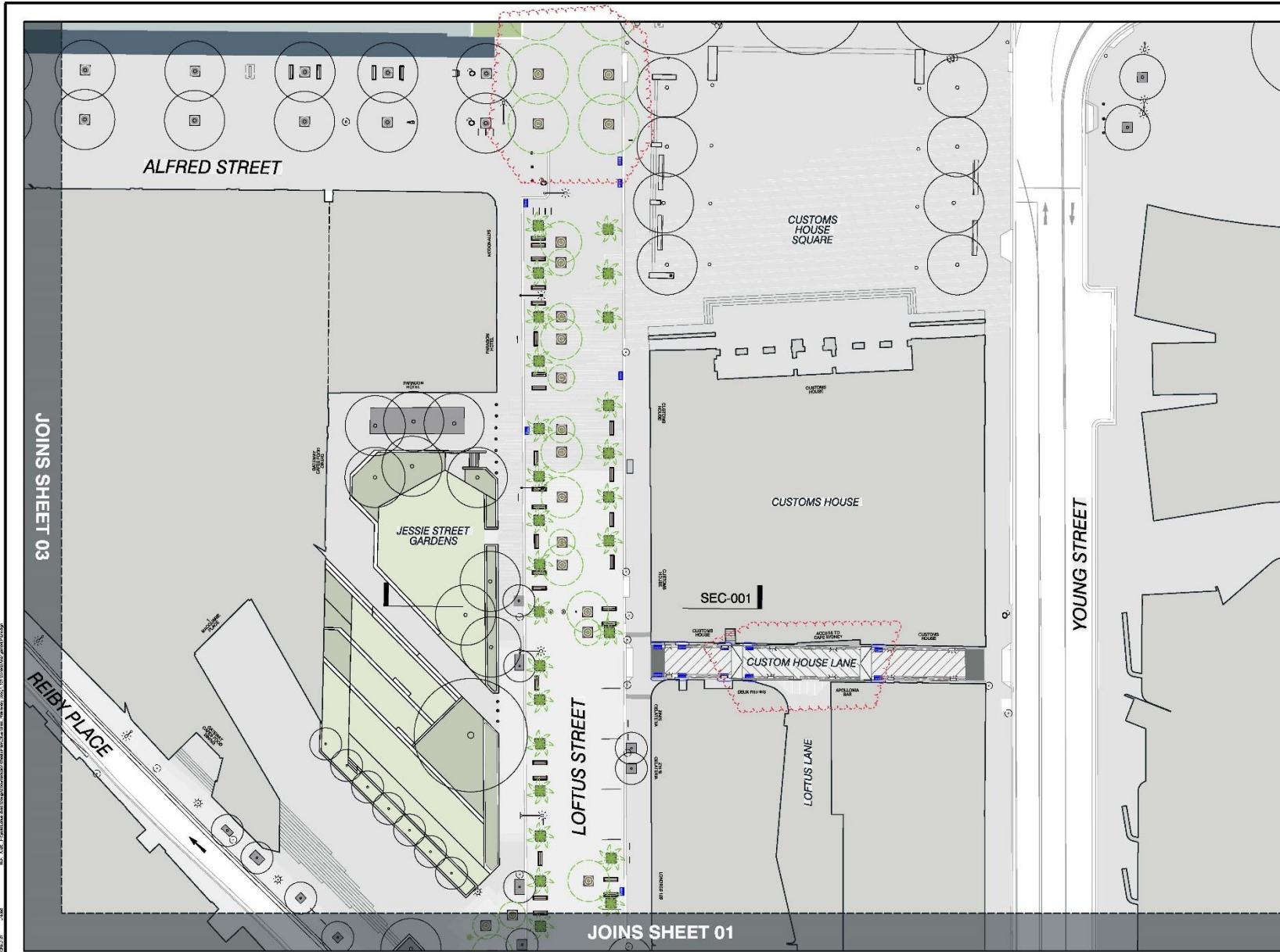

**LEGEND**

**PROPOSED**

- BENCH PROPOSED
- PLANTER PROPOSED BY OTHERS
- KIOSK EXISTING
- BIN (120L) PROPOSED
- BIKE RACK PROPOSED
- BOLLARDS TZANNES - FIXED
- BOLLARDS TZANNES - REMOVABLE
- BOLLARDS LEDA - FIXED
- BOLLARDS LEDA - REMOVABLE
- BOLLARDS LEDA - AUTOMATED RETRACTABLE
- LIVISTONA AUSTRALIS PALM TREE
- FLINDERSIA AUSTRALIS TREE
- TRISTANIOPSIS LAURINA TREE
- TREE PIT POROUS
- TREE PIT GRATE
- TRENCH DRAIN
- KERB INLET PIT
- STREETLIGHT POLE
- FLOOR LIGHT FITTING
- GALVANISED POST
- TCS CABINET

**EXISTING**

- TREE
- TREE PIT - POROUS
- TREE PIT - GRATE
- MAIN SWITCH BOARD
- GALVANISED POST
- STREETLIGHT POLE



Revisions	No.	Date	Description
A.	20.06.23	FOR REVIEW	
B.	21.07.23	ISSUE TO QUANTITY SURVEYOR	
C.	02.08.23	ISSUE TO QUANTITY SURVEYOR	
D.	22.08.23	ISSUE FOR TENDER	
E.	11.10.23	DESIGN UPDATE: BRIDGE/LOFTUS INTERSECTION ADDED LOFTUS ACCESSIBLE TAXI RAMP	

Drawings that do not show status have not been verified by City Design and are not to be used for any purposes other than for preliminary reference. All dimensions on site plans are approximate. Use figures dimensions only. Verify all dimensions on site before commencing works and refer any discrepancies to City Design.  
 The information contained in this drawing remains the property of City Design and is not to be reused or copied without permission.

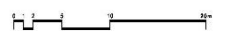

Designer  
**City of Sydney**  
 City Design Unit

Town Hall House  
 40 Kent Street  
 GPO Box 1379  
 Sydney NSW 2001  
 Telephone: 02 9399 9000  
 www.cityofsydney.nsw.gov.au



Project  
**Loftus Street**  
 Pedestrianisation

Project No.  
**C33035**



Drawing  
 Loftus Street  
 Preliminary Design - General Arrangements Plans

Drawing Status  
**PRELIMINARY**

Scale	Sheet Size	Sheet	Issue
1:250	A1	02 of 03	E

Drawing Number  
 DRG-102

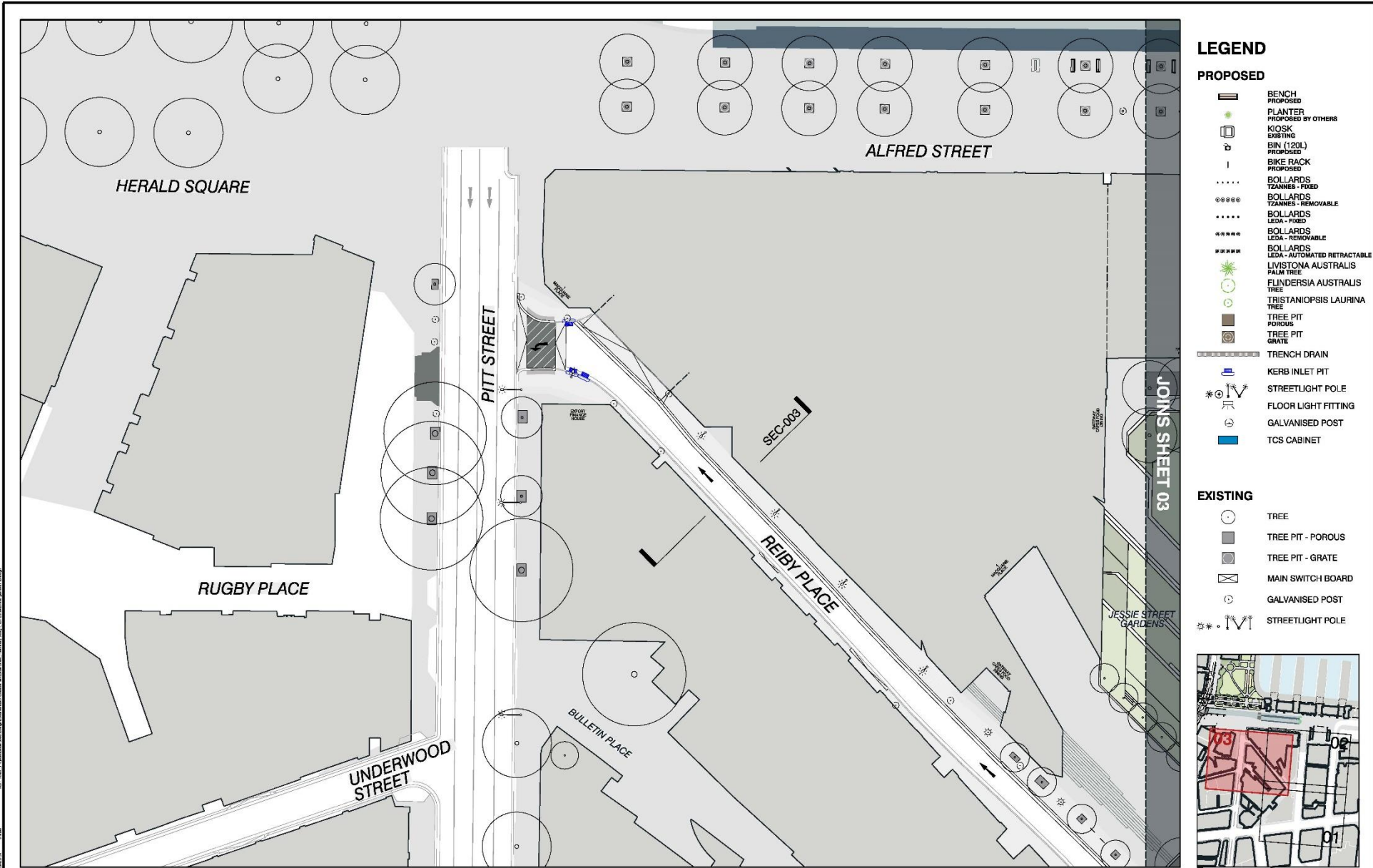

**LEGEND**

- PROPOSED**
- BENCH PROPOSED
  - PLANTER PROPOSED BY OTHERS
  - KIOSK EXISTING
  - BIN (120L) PROPOSED
  - BIKE RACK PROPOSED
  - BOLLARDS TZANNES - FIXED
  - BOLLARDS TZANNES - REMOVABLE
  - BOLLARDS LEDA - FIXED
  - BOLLARDS LEDA - REMOVABLE
  - BOLLARDS LEDA - AUTOMATED RETRACTABLE
  - LIVISTONA AUSTRALIS PALM TREE
  - FLINDERSIA AUSTRALIS TREE
  - TRISTANIOPSIS LAURINA TREE
  - TREE PIT POROUS
  - TREE PIT GRATE
  - TRENCH DRAIN
  - KERB INLET PIT
  - STREETLIGHT POLE
  - FLOOR LIGHT FITTING
  - GALVANISED POST
  - TCS CABINET
- EXISTING**
- TREE
  - TREE PIT - POROUS
  - TREE PIT - GRATE
  - MAIN SWITCH BOARD
  - GALVANISED POST
  - STREETLIGHT POLE

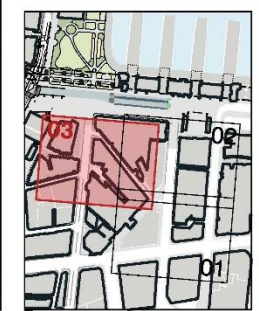

Revisions	
No.	Date
A.	20.06.23
B.	21.07.23
C.	02.08.23
D.	22.08.23
E.	11.10.23

FOR REVIEW  
 ISSUE TO QUANTITY SURVEYOR  
 ISSUE TO QUANTITY SURVEYOR  
 ISSUE FOR TENDER  
 DESIGN UPDATE  
 BRIDGE/LOFTUS INTERSECTION ADDED  
 LOFTUS ACCESSIBLE TAXI RAMP

Drawings that do not show status have not been verified by City Design and are not to be used for any business other than for preliminary information. All dimensions on site plans are approximate. Use figures for dimensions only. Verify all dimensions on site before commencing works and refer any discrepancies to City Design.  
 © Copyright  
 The information contained in this drawing remains the property of City Design and is not to be reused or copied without permission.

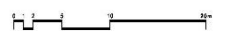

Designer  
**City of Sydney**  
 City Design Unit

Town Hall House  
 405 Kent Street  
 Sydney NSW 2000  
 Telephone: 02 9556 9000  
 www.cityofsydney.nsw.gov.au

**CITY OF SYDNEY**

Project  
**Loftus Street Pedestrianisation**

Drawing  
 Loftus Street  
 Preliminary Design - General Arrangement Plans

Drawing Status  
**PRELIMINARY**

Scale  
 1:250

Sheet Size  
 A1

Sheet  
 03 of 03

Issue  
 E

Drawing Number  
 DRG-103





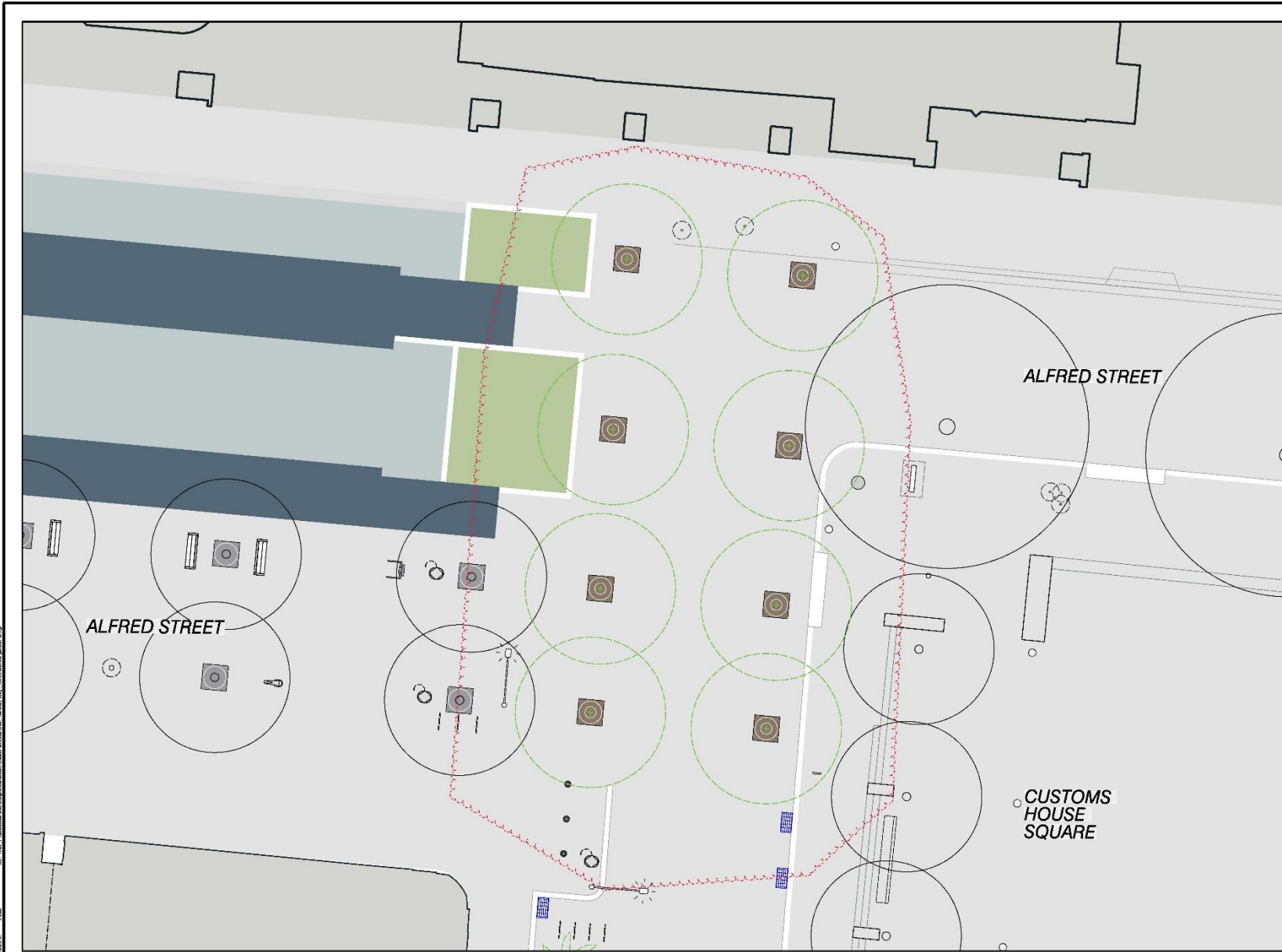

**LEGEND**

**PROPOSED**

- BENCH PROPOSED
- PLANTER PROPOSED BY OTHERS
- KIOSK PROPOSED
- KIOSK APPROVED DA LOCATION
- BIN (120L) PROPOSED
- BIKE RACK PROPOSED
- BOLLARDS TZANNES - FIXED
- BOLLARDS TZANNES - REMOVABLE
- BOLLARDS LEDA - FIXED
- BOLLARDS LEDA - REMOVABLE
- BOLLARDS LEDA - AUTOMATED RETRACTABLE
- LIVISTONA AUSTRALIS PALM TREE
- FLINDERSIA AUSTRALIS TREE
- TRISTANIOPSIS LAURINA TREE
- TREE PIT POROUS
- TREE PIT GRATE
- TRENCH DRAIN
- KERB INLET PIT
- STREETLIGHT POLE
- FLOOR LIGHT FITTING
- GALVANISED POST

**EXISTING**

- TREE
- TREE PIT - POROUS
- TREE PIT - GRATE
- MAIN SWITCH BOARD
- GALVANISED POST
- STREETLIGHT POLE

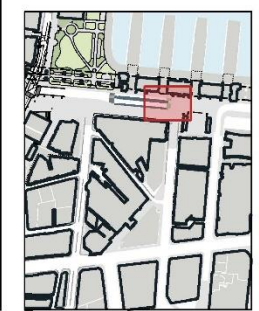

Revisions	No.	Date	Description
A	15.08.2023	ISSUE FOR TENDER	
B	11.10.23	DESIGN UPDATE: BRIDGE/LOFTUS INTERSECTION ADDED LOFTUS ACCESSIBLE TAXI RAMPS	

Drawings that do not show status have not been verified by City Design and are not to be used for any purpose other than for preliminary information. All dimensions on site plans are approximate. Use figures for dimensions only. Verify all dimensions on site before commencing work and refer any discrepancies to City Design.  
 © Copyright  
 The information contained in this drawing remains the property of City Design and is not to be reused or copied without permission.

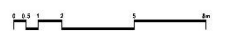

Designer  
**City of Sydney**  
 City Design Unit

Town Hall House  
 405 Kent Street  
 Sydney NSW 2000  
 Telephone: 02 9399 8000  
 www.cityofsydney.nsw.gov.au



Project  
**Loftus Street Pedestrianisation**

Project No.  
**C33035**



Drawing  
 Loftus Street  
 Preliminary Design - General Arrangement Plan

Drawing Status  
**PRELIMINARY**

Scale	Sheet Size	Sheet	Issue
1:100	A1	01 of 01	B

Drawing Number  
 DRG-104